

SP712

• Ticket • Fiscal • Data logging •



- High speed, up to 4.7 lps
- “Drop-In & Print” paper loading
- Flexible with different paper widths: 58 mm / 70 mm / 76 mm
 - Variety Interface options fit different system needs
- Paper Check Window enables checking the remaining paper without opening the cover
 - 18 Pin head allows printing Chinese Character in 1 pass
- Capable to print in two colours: Black and Red to highlight important information and print pleasant logos
 - Build-in Power Supply, no AC adapter is necessary
 - Paper Guide, Switch Cover included as standard



□Print Head□



□High Speed□

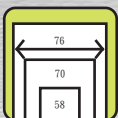

□Paper width□



□Various I/F□

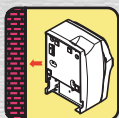

□Wall Mount□



□Dual Color□



□Internal PS□



□Easy Loading□



SP712



The New Star SP700 printers are enhanced not only in printing speed, but also in capability and reliability. It is a cost-efficient model which is ideal for restaurant, kitchen, retail and ticketing.

With SP700 series, you could print quality receipts and tickets at a faster speed than ever. SP700 printers incorporate with "Drop-in & Print" paper loading design, in just 3 simple steps, you could change the paper roll easily and quickly.

To satisfy different requirements, SP700 series comes with 9-Pin or 18-Pin version; Tearbar or Autocutter version. The 18-pin version, SP717 and SP747 allows printing Chinese characters in one single pass, doubling Chinese character printing speed.

Moreover, SP700 series provides variety of Interface options, from traditional Parallel Interface to advanced Ethernet Interface, to integrate with different system configurations.

Star has improved not only the hardware features, but also the software capabilities making day-to-day usage so much easier. We always plan ahead, driver for next generation Windows OS - Windows Vista is ready for SP700 printers.



SP712 9 Pin, Tear Bar Version
SP742 9 Pin, Autocutter Version
SP717 18 Pin, Tear Bar Version
SP747 18 Pin, Autocutter Version

Typical Applications

- Retail Point-of-Sale
- Ticketing
- Restaurant and Kitchens

Works with Windows Vista™

OPOS

Designed for Microsoft® Windows® XP

JAVAPOS™

Linux™

Compatible with majority of POS operating platforms with quality suite of drivers

SP700 Printer Specifications	
Printer Method	9 Pin / 18 Pin Serial Dot Matrix
Print Speed	Max. 4.7 lps (ANK 40 columns of continuous printing) Max. 5.5 lps (ANK 32 columns of continuous printing)
Print Direction	Bi-directional, Logic Seeking
Paper Feed Speed	Max.140 mm per second (when feeding continuously)
Number of Column	42 col (76mm paper) 32 col (58mm paper)
Character Matrix	7x9 (half dot), 5x9
Character size (mm)	1.19 (W) x 2.42 (H) / 1.49 (W) x 2.42 (H)
Character per inch (CPI)	16.9 / 14.1
Character Set	95 alphanumeric, 46 International, GB18030
Code Page	40 code pages
Paper Specifications	
Width	76 ± 0.5 mm ; 69.5 ± 0.5 mm ; 57.5 ± 0.5 mm
Diameter	Max. 85 mm
Thickness	0.07 to 0.10 mm
Copy Capacity	Original and two copies, Max. thickness 0.2 mm
Ribbon Colour	Black(RC700B) or Black/Red(RC700BR)
Black Mark Sensor	9 position
Paper End Sensor	Standard
Emulation	Star Mode / ESC/POS™ Emulation
Interface	USB / RS232C Serial / Parallel / Ethernet
Reliability:	
Mechanism	10 million Lines, MCBF 22 million lines
Print Head	150 million Characters
Autocutter	1 million Cuts
Overall Dimensions	160 (w) x 245 (d) x 152 (h) mm
Weight	Tear Bar version: 3.0 kg ; Autocutter version: 3.2 kg
Options	Wall Mount, Vertical Mount, Paper Roll holder, Buzzer

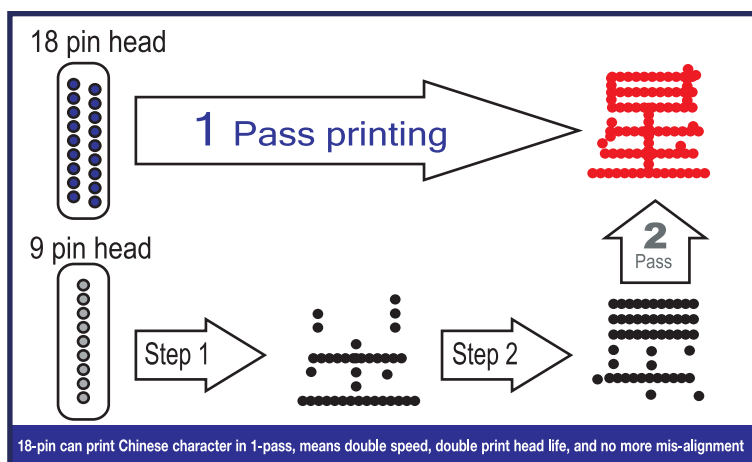

Manufacturer:
STAR MICRONICS CO., LTD
536 Nanatsushinya, Shimizu, Shizuoka, 424-0066, Japan