

# ASC COMPRESSION LOAD CELL



## DESCRIPTION:

The ASC is a single column, stainless steel compression load cell

This product is suitable for use in road and rail weighbridges and process weighing applications.

The welded construction and built-in surge protection ensure that this product can be used successfully in harsh environments.

## FEATURES:

- Self-aligning, stainless steel single column
- Hermetically sealed, IP66 and IP68
- Certified to OIML R60, **6000d**
- Built-in surge protection tubes (GDTs)
- Current calibration output (SC) ensures easy and accurate parallel connection of multiple load cells
- Digital version available (model DSC)
- **Capacities: 30, 40 and 50t**

# ASC: SPECIFICATIONS

Capacity	$E_{max}$	t	30, 40, 50				
Accuracy Class According to OIML R60				C3	C4	C5	C6
Maximum Number of Verification Intervals	$n_{ic}$			3000	4000	5000	6000
Minimum Verification Interval ( $v_{min} = E_{max}/Y$ )	$v_{min}$		$E_{max}/6000$	$E_{max}/8000$	$E_{max}/10000$	$E_{max}/12000$	
Minimum Verification Interval, <b>Type MR</b>	$v_{min}$		$E_{max}/15000$	$E_{max}/16000$	$E_{max}/25000$	$E_{max}/30000$	
Accuracy Class According to Type Designation <sup>1</sup>			CC	C3	C4	C5	C6
Combined Error		%S	$\leq \pm 0.050$	$\leq \pm 0.023$	$\leq \pm 0.018$	$\leq \pm 0.014$	$\leq \pm 0.012$
Hysteresis		%S	$\leq \pm 0.050$	$\leq \pm 0.017$	$\leq \pm 0.013$	$\leq \pm 0.010$	$\leq \pm 0.008$
Minimum Dead Load Output Return	MDLOR	%S	$\leq \pm 0.050$	$\leq \pm 0.017$	$\leq \pm 0.013$	$\leq \pm 0.010$	$\leq \pm 0.008$
Minimum Dead Load Output Return, <b>Type MI7.5</b>	MDLOR	% $S_{nom}$		$\leq \pm 0.0067$	$\leq \pm 0.0067$	$\leq \pm 0.0067$	
Non-Repeatability	$E_R$	%S	$\leq \pm 0.070$	$\leq \pm 0.035$	$\leq \pm 0.026$	$\leq \pm 0.021$	$\leq \pm 0.018$
Creep Error (30 Minutes)		%S	$\leq \pm 0.060$	$\leq \pm 0.025$	$\leq \pm 0.018$	$\leq \pm 0.015$	$\leq \pm 0.012$
Creep Error (20-30 Minutes)		%S	$\leq \pm 0.0200$	$\leq \pm 0.0053$	$\leq \pm 0.0039$	$\leq \pm 0.0032$	$\leq \pm 0.0026$
Temp. Effect on Minimum Dead Load Output	$TC_o$	% $S_{nom}/5^\circ C$	$\leq \pm 0.0250$	$\leq \pm 0.0117$	$\leq \pm 0.0088$	$\leq \pm 0.0070$	$\leq \pm 0.0058$
Temp. Effect on Minimum Dead Load Output, <b>Type MR</b>	$TC_o$	% $S_{nom}/5^\circ C$		$\leq \pm 0.0047$	$\leq \pm 0.0044$	$\leq \pm 0.0028$	$\leq \pm 0.0023$
Temperature Effect on Sensitivity	$TC_s$	%S/ $5^\circ C$	$\leq \pm 0.0250$	$\leq \pm 0.0088$	$\leq \pm 0.0065$	$\leq \pm 0.0053$	$\leq \pm 0.0045$
Minimum Dead load	$E_{min}$	% $E_{max}$	0				
Safe Load Limit	$E_{lim}$	% $E_{max}$	150				
Ultimate Load	$E_{ult}$	% $E_{max}$	300				
Deflection at $E_{max}$		mm	0.50				
Excitation Voltage		V	5 ... 20				
Maximum Excitation Voltage		V	25				
Rated Output	$S_{nom}$	mV/V	$2 \pm 0.02$				
Current Calibration	SC-version		Standard				
Zero Balance		% $S_{nom}$	$\leq \pm 1.0$				
Input Resistance	$R_{in}$	$\Omega$	$700 \pm 35$				
Output Resistance	$R_{out}$	$\Omega$	$700 \pm 7$				
Insulation Resistance	$R_{ins}$	M $\Omega$	$\geq 5000$				
Compensated Temperature Range	$T_{cps}$	$^\circ C$	-10 ... +40				
Operating Temperature Range	$T_{opr}$	$^\circ C$	-40 ... +80				
Storage Temperature Range	$T_{srg}$	$^\circ C$	-40 ... +90				
Element Material			Stainless steel 1.4542				
Sealing (DIN 40.050 / EN 60.529)			IP66 and IP68				

1 The specified accuracies apply for the compensated temperature range.

**SC-version:** The rated output and the output resistance are balanced in such a way, that the output current is calibrated to within 0.05% of a reference value. This allows easy parallel connection of the load cells.

Correct mounting of the load cells is essential to ensure optimum performance.  
Further information is available on request.

**Cable specifications:**

Cable length 15m

Excitation +	Green
Excitation -	Black
Output +	White
Output -	Red
Shield	Transparent

Shield is not connected to the load cell body.  
All dimension tolerances according to ISO 2768m, unless otherwise specified.

Also available:  
**Self Aligning Set ASC and DSC**  
For more information:  
Assembly Guideline 02/3-110/01.

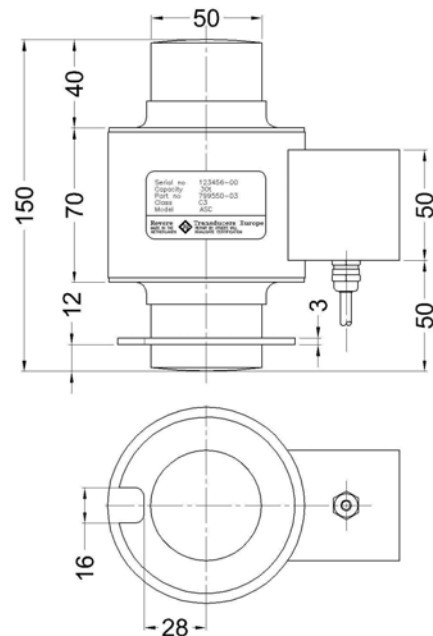

All specifications subject to change without notice.

**REVERE TRANSDUCERS EUROPE B.V.**  
Ramshoorn 7  
Postbus 6909, 4802 HX Breda  
The Netherlands  
Tel.: (+31) 76-5480700  
Fax.: (+31) 76-5412854  
E-mail: [info@revere.nl](mailto:info@revere.nl)  
Website: [www.revere.nl](http://www.revere.nl)

**REVERE TRANSDUCERS INC.**  
14192 Franklin Ave  
Tustin, CA 92780-7016  
U.S.A.  
Tel.: (+1) 714.731.1234  
Fax.: (+1) 714.731.2019  
E-mail: [info@reveretransducers.com](mailto:info@reveretransducers.com)  
Website: [www.revere.nl](http://www.revere.nl)

**REGIONAL OFFICE UK**  
The Business Centre  
Edward Street, Redditch  
Worcs B97 6HA, UK  
Tel: (+44) 1527-65888  
Fax: (+44) 1527-64888  
E-mail: [alittlejohn@revere.nl](mailto:alittlejohn@revere.nl)